



Vlaanderen
is natuur



Welcome to
THE MUSEUM GARDEN

AGENTSCHAP
NATUUR & BOS



A garden of European excellence

In the nineteenth century and until around WW II, our country enjoyed a leading position in the international field of horticulture and fruit farming in particular.



The Gaasbeek Museum Garden takes visitors right back to those glory days. In association with the Agency for Immovable Heritage, the Agency for Nature and Forests has put all its know-how and passion into building a garden of unrivalled beauty, taking its cues from the castle gardens as they were in the 19th century. A masterly example of living cultural heritage.



The focal point is the garden's unique collection of fruit trees in espalier shapes. The Museum Garden is also home to forgotten vegetables and fruits, such as medlar, quince, Jerusalem artichoke... but equally much less well known fruits, such as sea kale, blitum, and walking stick kale.

The Museum Garden is fragile, therefore dogs are not allowed.

The Gaasbeek Museum Garden is around 5 acres in size, located in stunning surroundings within Gaasbeek Estate, with a view of the Castle and a ten-kilometre panoramic vista of the Pajottenland. Also open to visitors in the local area are the Castle Museum, Gaasbeek Park and Groenberg Park with its unique collections. Well worth a visit.

FURTHER INFORMATION

Agentschap voor Natuur en Bos

anb@vlaanderen.be - www.natuurenbos.be

Photos: Eddy Vangroenderbeek, Jurgen Van der Crujssen, An Wouters, Bart Van Camp

Responsible editor:

Jeroen Denaeghel, Herman Teirlinckgebouw, Havenlaan 88 (bus 75), 1000 Brussel. (august 2023)

Information and bookings:

For opening hours and bookings, go to our website.

Guided tours are possible for groups up to 20 people. A tour takes an hour and a half and costs € 60 per guide + an entrance ticket per visitor. Fill out the form on our website to request one or more guides.

www.natuurenbos.be/museumgarden



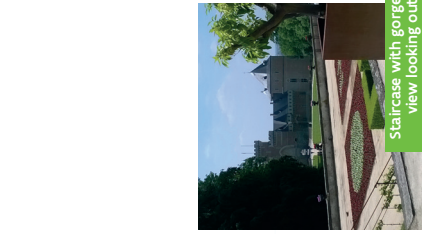

Staircase with gorgeous view looking out onto the Castle and Peijottenland.



Kitchen garden



Greenhouse

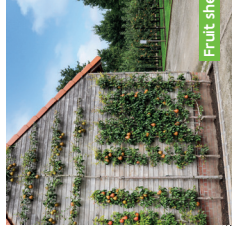

Fruit shed

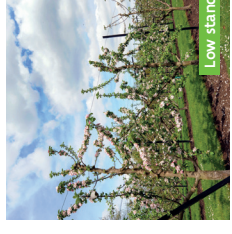

Low standard orchard



Full standard orchard

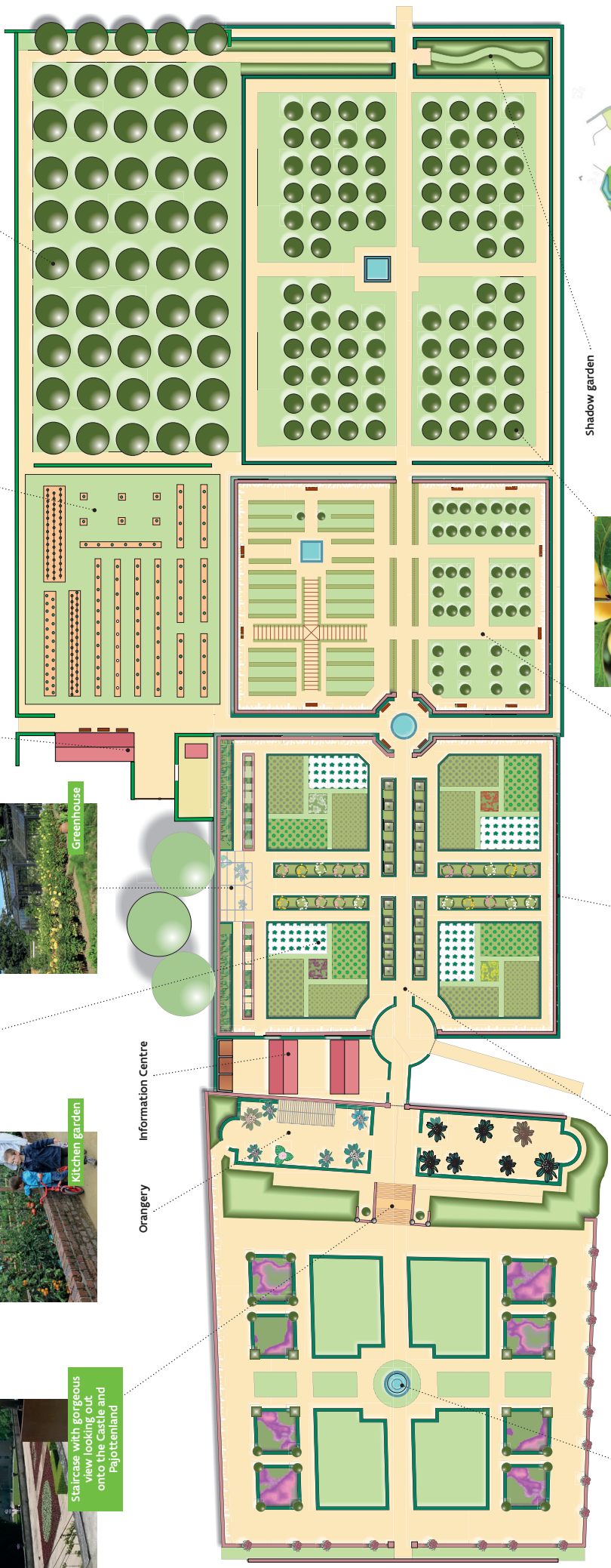

Shadow garden

Directions:

The Museum Garden is situated inside Gaasbeek Estate. The estate is easy to reach from exit 15a on the Brussels Ring Road. Drive straight ahead through Vizezenbeek village centre as far as the next roundabout, where you take a right. This road runs between Gaasbeek Estate and Groenberg Estate. There is plenty of parking space on your left. The Museum Garden is just nearby.

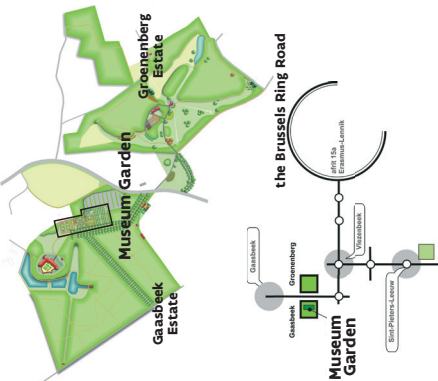

Half standard plum orchard



Berry garden



Walls in field-oven brick



Master's Walk

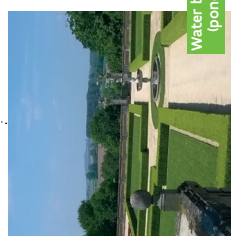

Water basin (pond)